

s.tec
GERMANY



Your **expert** in
source extraction systems.

For many decades, s.tec has been successfully active as the leading manufacturer in the field of source extraction of gases, fumes and dust.

From designing, components and assembly to commissioning, s.tec carries out the complete program for the source capturing of smoke, dusts, exhaust gases and overspray. Settled in Hagen / Germany, s.tec offers an international scope combined with cutting-edge developments and

products „Made in Germany“. s.tec provides solutions that cover a large range of applications including extraction equipment for lawn mowers and diesel locomotives. s.tec reputation in Germany and throughout the world with major automotive manufacturers speaks for itself.

MultiSpeedMaster



Our innovative **MultiSpeedMaster** concept is the ideal solution for all requirements in the smart repair sector. It enables you to carry out all the necessary repair work, from grinding to drying paint, in a very small area.

Special systems



Our services also encompass individual custom equipment such as for agricultural and construction machinery, diesel locomotives and emergency power generators.

Exhaust gas extraction systems



We offer SLS systems as our solution for a diverse range of needs in the area of low-energy consuming exhaust extraction. Planning customised systems is what we do best.

Welding fumes & filter technology



Our fume and dust filtering systems meet all the latest standards for occupational safety. They efficiently extract dust and nanoparticles and ensure a better level of health protection for your employees.

High vacuum



We deploy our high vacuum systems in a targeted way to guarantee a high degree of extraction and efficient filtering while maintaining low energy consumption.

State-of-the-art extraction technology – *experience and progress from one source!*

Our solutions for exhaust extraction systems guarantee perfect and custom designed installations. All our standard equipment has received the 'GS' mark to certify safety.

The very latest extraction technology, e.g. automated mechanical butterfly valves and intelligent electronic control units ensure **high efficiency**. Our equipment can be constructed over large spaces and be expanded at any time with little effort.



Our **aluminium rail systems** provide the advantage of ensuring extraction throughout your workshop. They are available in various sizes and lengths.

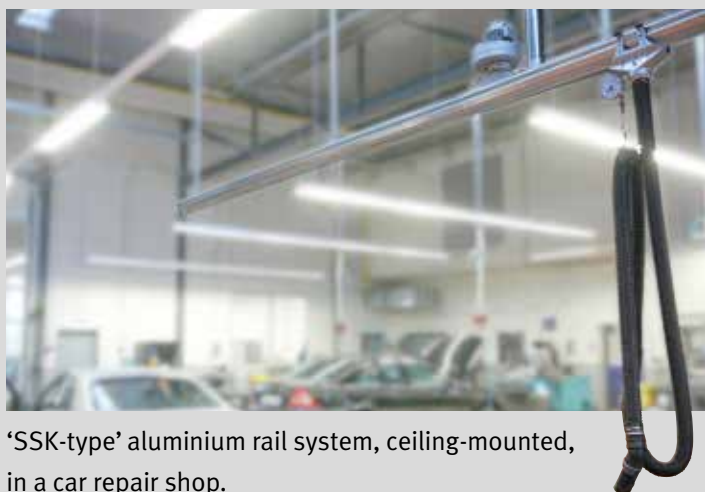

'SSK-type' aluminium rail system, ceiling-mounted, in a car repair shop.



They can also be used on truck test stations.



Aluminium rail systems enable reaching all the areas of your workshop, in contrast to other extraction systems.

But also for simple extraction tasks in workshops we have a solution called 'MiniSet'. With our underfloor equipment, the extraction systems for service workstations, and performance test stations we are sure to have the right product to meet your requirements.



The hoses and funnels used have been developed with the challenges of the latest generation of vehicles in mind. We also offer **special models** for use under extreme conditions.



Our mechanical and electrical hose reels are available in various nominal widths (DN 75 to DN 250) and with hose lengths of up to 15m.



Our hose reel as a stand-alone solution ...



... or movable in the aluminium rail system.

SLS systems – leading the way in many sectors!

Our patented SLS technology is the future-orientated way of capturing car exhausts.



Overview of the benefits:

- Easy operation
- Simple to position
- Quick and efficient service times
- Capturing of exhaust from nearly all generations of exhaust pipes
- Covers all vehicles with short and long wheelbases on conventional lifting platforms
- Capturing and extraction elements move with the vehicle as it lifted/lowered on the platform



We offer individual solutions for car and truck test stations.



Double exhaust systems are no problem.



Fire and rescue service – when every second counts!

We also have the ideal solution for the emergency services. We have developed a special system since every second counts – the FireMaster series.

The term FireMaster stands for optimum solutions at every scale, ranging from small volunteer fire departments to profession fire brigades or task forces at airports.

The main idea behind all FireMaster systems is automatic disconnection once the fire station has been vacated.

Its design enables personnel to drive off into action without waiting. Deployment speed is negligible so valuable time is saved.

Hose guidance is located near the vehicle in all cases to provide for unrestricted freedom of movement.

The dangerous swinging of the hose after detachment is reduced to a minimum by our system.

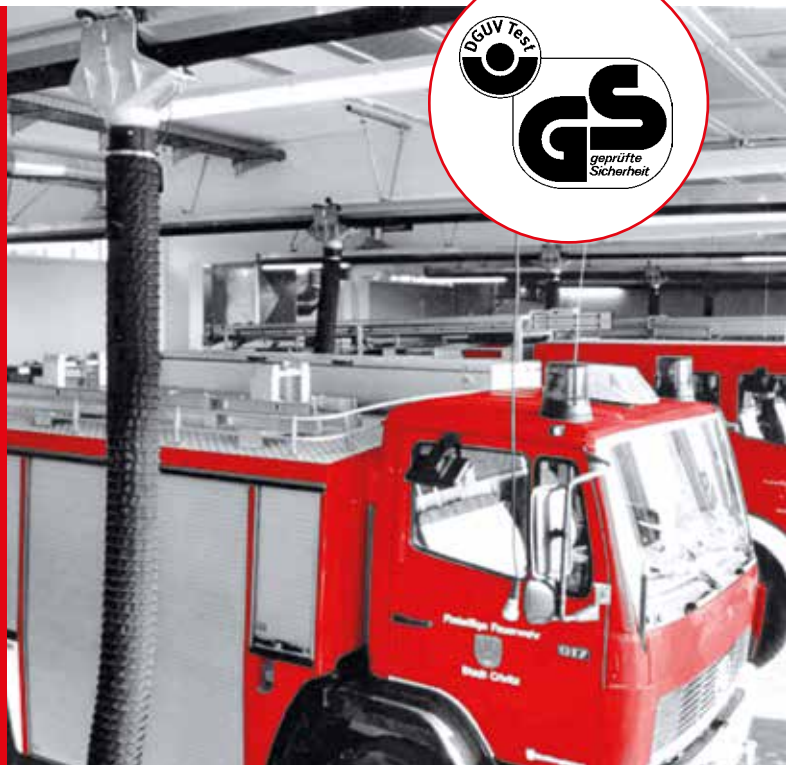

The systems can also be equipped with a direct start-up fan which initiates when the vehicle is started.

Our TopLine and Airpulse system have also received the GS mark to certify that they are safe.



The magnetic coupling can be flexibly mounted depending on the vehicle.



Ceiling guidance near the vehicle ensures freedom of movement.

Special systems – solutions for XXL vehicles

We offer individual solutions for agricultural and construction machinery in addition to our standard installations.

The special requirements of structural and vehicle-specific circumstances are taken into consideration through the targeted use of our components.



Extraction unit for overhead exhausts.



Diesel locomotive-extraction with pivoting side arm.

Welding fumes & filter technology – *extraction when and where you want it!*



Our equipment meets the latest standards of occupational safety in the field of fume and dust filtering technology.

During repairs, it is not only small particles but also **microscopic nanoparticles** that are produced. Our systems also capture, extract and filter the tiniest of particles.

Targeted extraction enables the **capturing of large amounts of pollutants** and at the same time **reduces your energy needs** despite minimal air exchange.



Our solutions for welding jobs/operations meet all the current DIN standards.



Airflow control and smooth handling allow use on single and centralized systems.



High vacuum – *concentrated performance*



The use of high vacuum equipment is widespread nowadays since the dangers of dust particles released through grinding are well known (paint preparation, machining aluminium, glass fibre composites and carbon).

Our large variety of models covers all types and sizes of grinding stations.

The interior cleaning of vehicles with central, professional high vacuum equipment is another of our services. The capturing elements we use are energy lights, dust ducts and high vacuum hose reels with appropriate accessories.

The amount required to be extracted can be adapted to requirements through manual and automatic air volume control, enabling energy-efficient filtering of pollutants.

Our filter systems feature a modular system and can be used in single- as well as in large centralized plants.



High vacuum equipment allows large amounts of pollutants to be captured.





The MultiSpeed-Master – *sophisticated and tested complete package!*



Our MultiSpeedMaster is a professional solution that meets all the requirements of the smart repair sector.

The system comprises three components:

- 'Hardware' for the construction of the station
- Training, practice and know-how for operations
- Specially prepared accessories and consumables

The equipment consists of a light-weight steel frame resting on four pillars which is surrounded by a transparent curtain. It can be integrated in any part of the workshop and requires only 4.5 x 7m of space.

The basic framework is self-supporting. It separates off the smart repair workstation from the workshop while still being able to incorporate the required installations such as easily movable supply and exhaust hoods with integrated filter technology. The equipment is not subject to approval due to the low level of pollutants in spot repair and has also received the GS mark for safety.

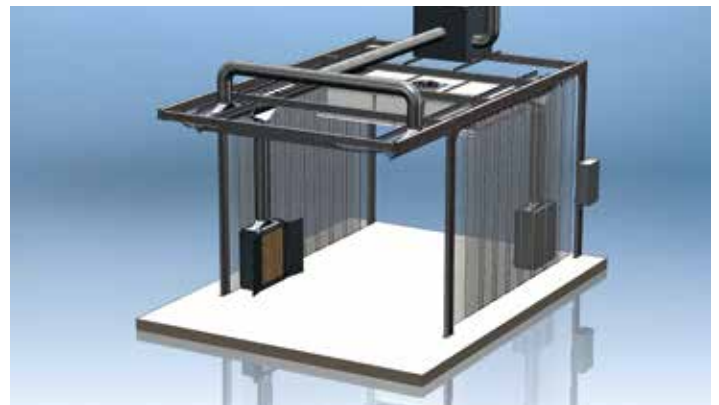

Overview of the benefits:

- Logistics:** Short reaction and delivery times
- Time savings:** Grinding and filling, painting and drying take place at a workstation
- Energy efficiency:** Very low energy costs through innovative technology
- Quick return on investment**
- Health protection:** Compliance with the requirements of occupational health and safety

International **experience** –
worldwide **service**.



s.tec Germany GmbH
Im Löhken 3-5 · 58099 Hagen
Tel.: +49 (0) 23 31 - 3 62 79 - 0
Fax: +49 (0) 23 31 - 3 62 79 - 36



We are member!
Federal association of manufacturers
and importers of automotive service
equipment r.a.

info@s-tec-germany.de · www.s-tec-germany.de